

Government of India  
Bhabha Atomic Research Centre  
Advanced Technology Systems Section

Ref: ATSS/E&IG/18/ 023

Date: 06/02/2018

Sub: Fabrication of SS Fittings and Powder Coated MS Table as per Annexure - 1

Dear Sir/Madam,

Quotations are invited for the "Fabrication SS Fittings and Powder Coated MS Table as per Annexure - 1

1. Bidder shall quote for fabrication and supply of parts along with material.
2. Taxes and Excise Duties shall be quoted separately. Form AF / H whichever is applicable shall be provided, if required.
3. The quotation must reach by Speed Post to The Head, Advanced Technology Systems Section by 16th Feb, 2018 and must be sent in a sealed envelope super scribed with the reference number & the due date given above.

The address on the envelop should read:       Head, ATSS, E&I Group,  
RCnD Bldg., North Site  
BARC, Trombay,  
Mumbai - 400 085.  
(Attn: Mr. R. K. Sharma, Ph.: 022 25591811/42)

4. The testing shall be witnessed by our engineer. The tested components shall not be dispatched prior to approval by our engineer at bidder's premises. Necessary inspection facilities shall be provided to our engineer during fabrication at bidder's premises.
5. The bidder shall deliver the finished components after approval by our engineer within 3 months from the date of firm work order issued to the bidder. The finished components shall be delivered by the bidder at ATSS, E&I Group BARC, Trombay, Mumbai - 400 085.
6. Head, ATSS, E&I Group reserves the rights to accept / reject any or all quotations without assigning any reason.
7. Delivery charges if any must be clearly mentioned in the offer. Quotation must also indicate the validity of offer. Quotation must also indicate the GST no and PAN no of the party.
8. Drawings / Sketches must be returned along with the offer.
9. The quotation has to be signed by authorized person with company seal.
10. Payment will be made by cheque only after satisfactory completion of work on production of bill, delivery challan and advance stamped receipt. It may be noted that IT @ 2% and surcharge on tax at 15% shall be deducted from your bills.
11. Part supply is not acceptable.
12. Job should be guaranteed against material and manufacturing defects for 1year from the date of supply.

Encl.: Annexure - 1

(R. K. Sharma)  
SO/F, ATSS, E&IG

(R. K. Sadhu)  
Head, ATSS, E&I Group

Annexure 1. (Page:1-6)

Fabrication of SS Fittings and Powder Coated MS Table and HDPE cylinder as per below descriptions (Items 1-4):

Item 1: SS Fittings for as per below drawing-12 Nos.

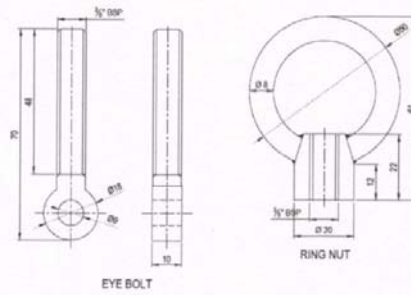

Item 2: SS blind End cap for KF 25 fitting with gasket as below: 8Nos.

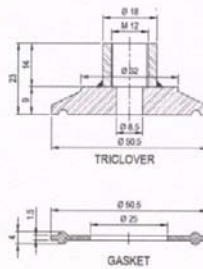

Item 3: High Density Polyethylene (HDPE) material Cylinder as below description: 1No.

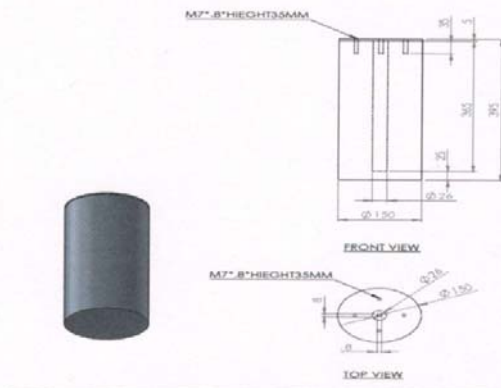

Assembly

(Page:1/6)

राशुनिका

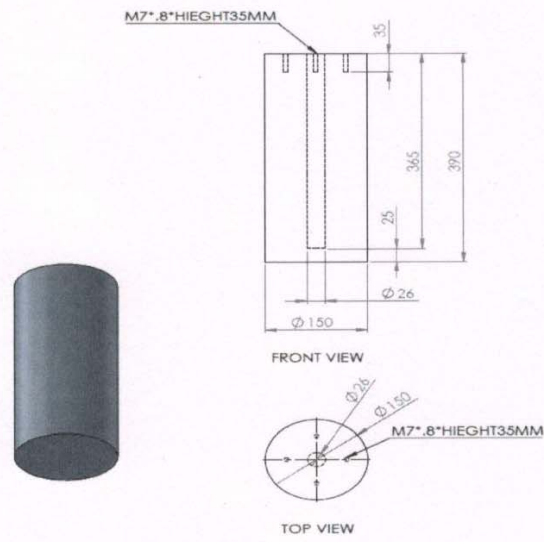

Main body

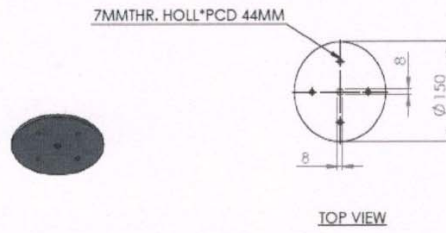
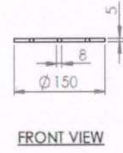

Disc with CSK holes

2023/12/26

Item 4: Powder coated MS table-1No. (as per below descriptions)

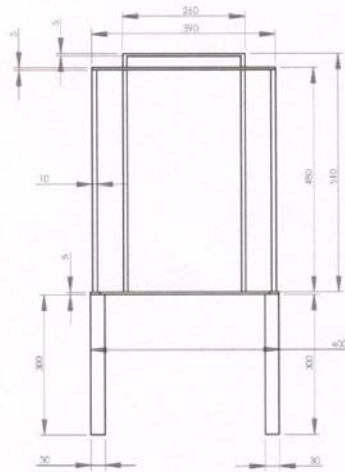

SIDE VIEW

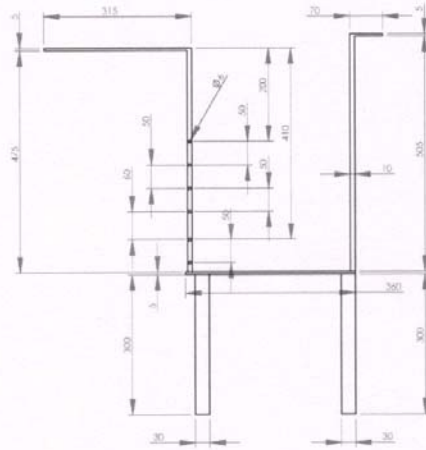

FRONT VIEW

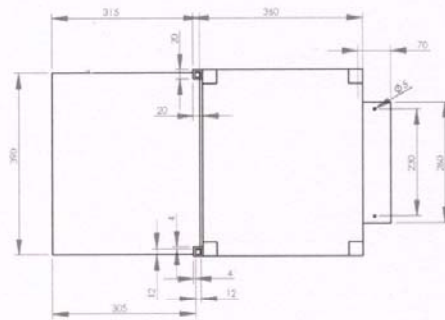
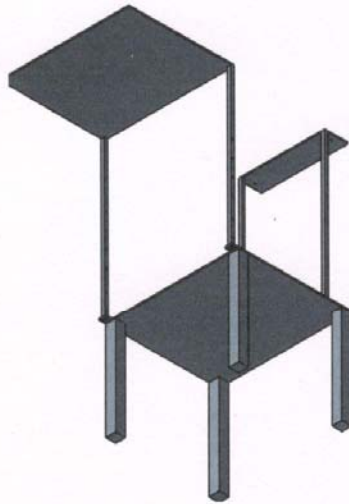

TOP VIEW

JOB- MS TABLE  
QUANTITY-01

To hold the overall weight of 60kg. any dimension can be changed to achieve the weight holding capacity.

(Page:3/6)

RAJESH K

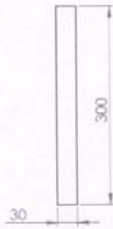

SIDE VIEW

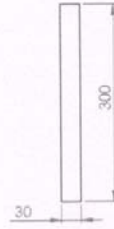

FRONT VIEW



TOP VIEW



Material -MS

All Dimension are in mm.

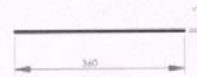

FRONT VIEW

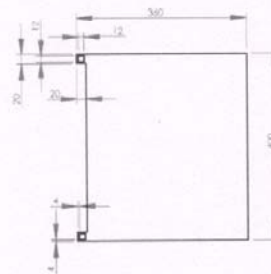

TOP VIEW

To hold the weight of 5kg.

(Page:4/6)

2 Ans 3 m 2 8 m 6

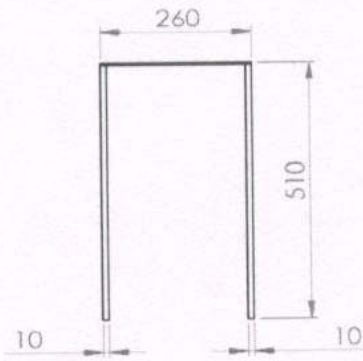

SIDE VIEW

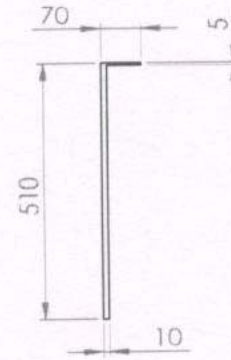

FRONT VIEW

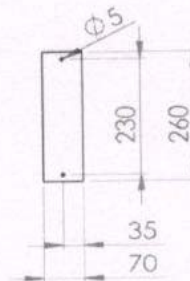
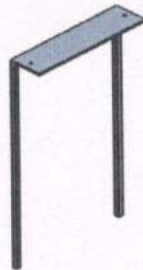

TOP VIEW

Material MS

All dimension are in mm.

'This will be welded at the top of the central plate.'

To hold the weight of 5kg.

(Page:5/6)

2023/12/21

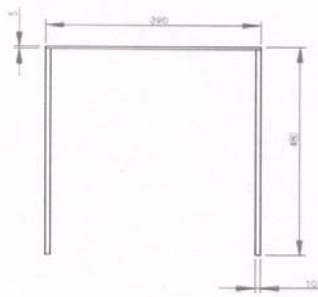

SIDE VIEW

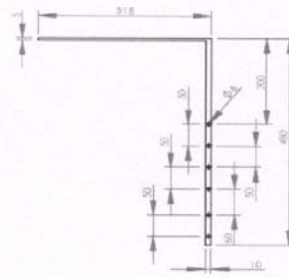

FRONT VIEW

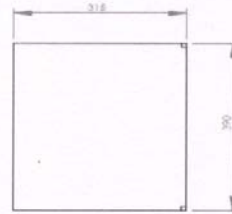
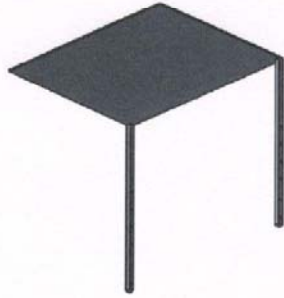

TOP VIEW

MATERIAL- MS

All Dimension are in mm.

'Holes and key system will vary the height of this plate'

(To hold the weight of 5kg.)

(Page:6/6)

*2As3nizem6*