



**R. K. Rajawat**  
Head, APPD.

Government of India  
BHABHA ATOMIC RESEARCH CENTRE  
Accelerator and Pulse Power Division  
Mumbai-400085- INDIA



**Engg. Hall No.4, Trombay,**  
Tele: +9122)25593785  
Fax: (+9122)25505151

**Ref.: BARC/APPD/MRK/2018/107**

**Date: 06.12.2018**

Subject: Inviting quotations for Minor Fabrication of “**Aluminum partitioning, Metallic Storage and Supply of furniture**” for three Sitting rooms at Engineering Hall No.9”, as per Annexure-I details.

S.No	Description of the Job	Quantity
1.	<b>Aluminum partitioning, Metallic Storage and Supply of furniture” for three Sitting rooms at Engineering Hall No.9, as per Annexure-I details.</b>	As per Annexure-I

Terms and Conditions:

1. The supplier should quote for fabrication of the item, including the cost of the materials. No free issue material will be provided by BARC.
2. The material will be inspected before the start and supply of the fabrication.
3. The quotations should have the minimum validity period of two months.
4. BARC being a Government organization is exempted from payment of excise duty. However, excise duty exemption duty exemption certificates will be issued if required. Five percent GST as applicable.
5. Supplier should submit their offers in their letterhead, placed in sealed envelope super scribed with the above mentioned Reference No., Due date and Title “**Quotations for Aluminum partitioning, Metallic Storage and Supply of furniture” for three Sitting rooms at Engineering Hall No.9**”. Kind attention: Shri. M.R.Kulkarni addressed to Head APPD, Hall-4, BARC, Trombay, Mumbai-400085, **on or before 24/12/2018** . The quotation should contain the following details like (i) Period of validity, (ii) terms and conditions of offer, (iii) Approximate period of completion of job, (iv) Copies of registration and income tax clearance certificates (v) PAN, GST and registration No. The quotations received after the due date & by FAX/email will not be considered.
6. The purchaser has the right to make the minor modifications in the layout or storage pattern. Additional charges will not be admissible for such minor modifications, if any. The item should be delivered to Engg.H.No.9 at designated Rooms, BTDG/BARC, Trombay, Mumbai-400085, after approval by our Scientists / Engineers.
7. Please note that shorter delivery period will be preferred. For any clarification you may contact shri.M.R.Kulkarni. PPSS/APPD, BARC on tel. 022-25594701
8. Payment will be made only after delivery and testing of the items to the above mentioned address and approval by scientist/engineers as per BARC rules.
9. AD, BTDG APPD has authority to cancel the bidding process at any time without assigning any reasons
10. Parties are requested to quote for whole work. Quotation for partial work will not be consider for evaluation and will be rejected.

Sd-  
(R.K.Rajawat)  
Head APPD & AD BTDG

Copy to: AAO (Works)

## ***Annexure-I***

*There are Three Rooms (Sitting halls for scientist/engineers), located in Engg,H.No.9, BARC, belongs to BTDG, In all three rooms Aluminum partitioning have to be provided by the supplier. They also provide the furnitures as enlisted in their respective room details (tables, chairs and compartments) and provide the metallic storage facility for storing the materials and documents. Each storage is custom made suitable to location. Supplier have also to provide white boards with makers, glass tops for specific tables and telephone device stand.*

Each Room Details requirements are listed below.

### **Room No. 1:**

- Size:~ 5.5m X 7.7m x 3m (hight)
- Requires two cabinets of sizes 4.1m X 2.7m X 3m (h) having 4.1mX 3m common partition (Total partitioning area: ~ 30sq.m)
- Two storage metallic campatments of sizes 2.7m X1.1m x 0.5m (~3 Cubic M) with grinite top. ( Maximum)
- Vertical Venetial blind window coverage :~ 5.5m X 2.0 m
- Fire proof executive office table with Glass Top ~1665mm(W) x 300mm(D) x 725mm (H) with three drawer at each side: 2Nos.
- Fire proof computer tables ~1200m (w) x 450mm (W) x 750mm (h)
- High Back Chairs: 2Nos
- Guest low back chairs: 8Nos.
- 4ft x 3 ft white board with marker pens and dusturs: 2sets
- Custom made “ [ ” table for student corner with provision for computer.
- Gas/water pipe line utility covering : ~2m x0.5m X1.5m

The details 3D layout is shown is shown in successive Page.

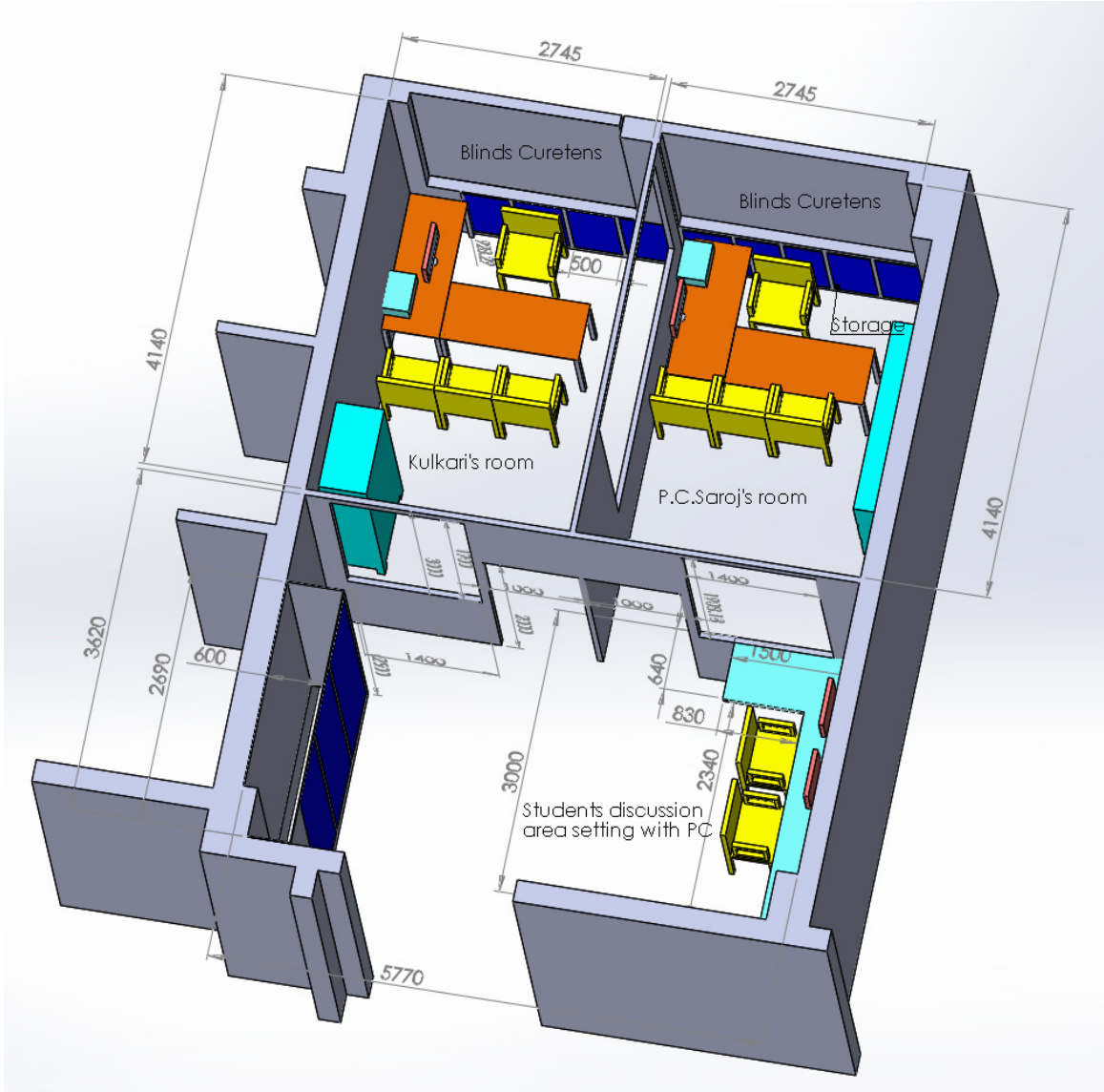

Room No.1 (APPD)

## Room No. 2:

- Size: 12.5m X 7.7m x 3m (height)
- Requires two cabinets of size 4.1m X 3.0m X 3m (h) having 3.0m X 3m common partition (Total partitioning area: ~ 54sq.m)
- Three storage metallic compartments of sizes 12.0m X 1.1m x 0.5m (~7 m<sup>3</sup>).with granite top .
- Vertical Venetian blind window coverage :~ 12m X 2.0 m = 24sq.m
- Working “L” shaped table including provision for placing computers and printers, MASTREO Model, Godrej Make: 2Nos.
- High Back Chairs: 2Nos
- Low back chairs: 10Nos.
- 4ft x 3 ft white board with marker pens and dusters: 2Nos
- Fire proof “ L ” type compartment cum table with one set of drawer modules with provision for computer(~6’ X 5’) :2 sets
- Gas/water pipe line utility covering : (~2m x 0.5m X 1.5m) x 2Nos=3.0 sq.m

The details 3D layout is shown is shown in successive Page.

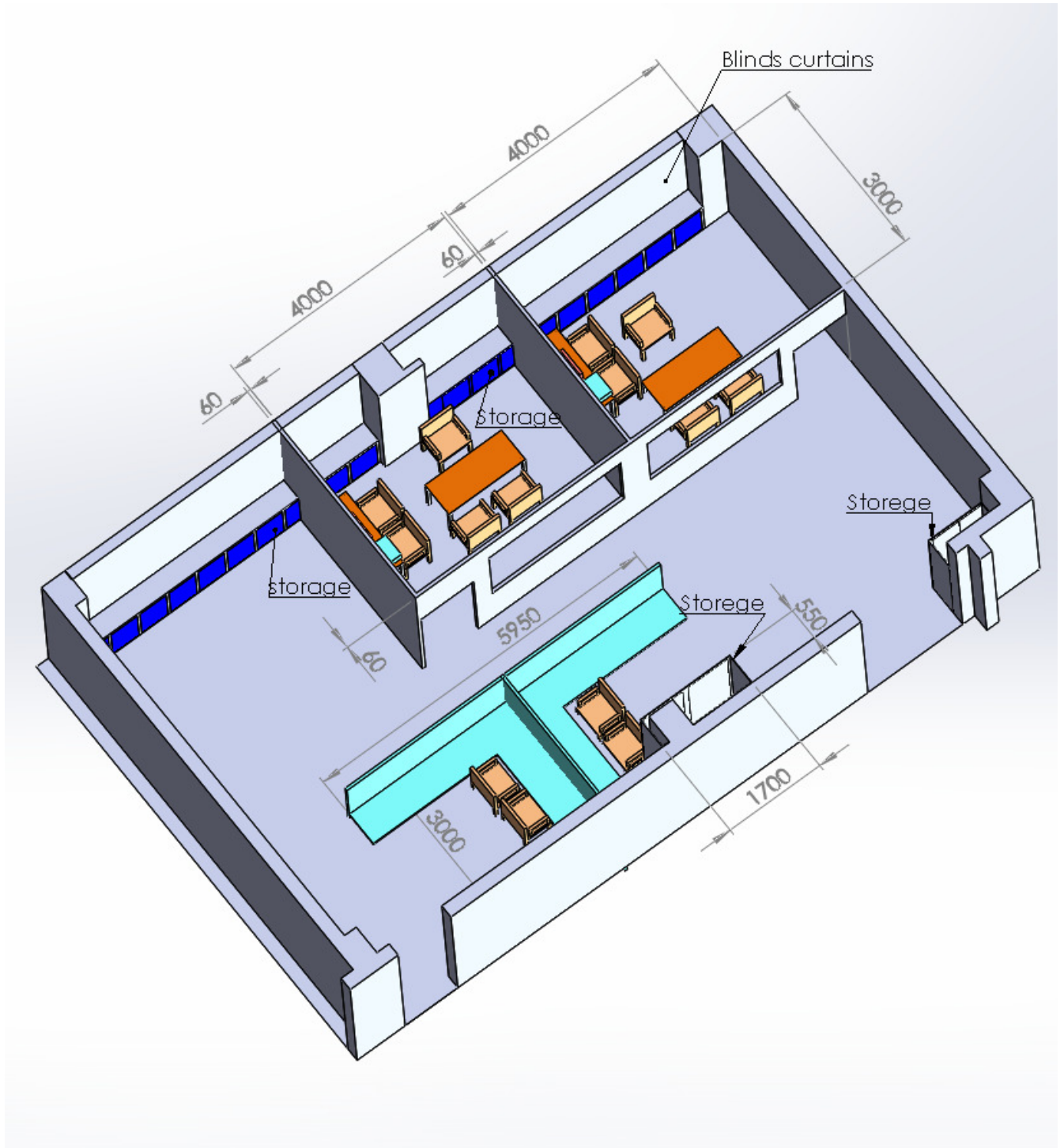

Room No.2 (L&PTD)

### Room No. 3:

- Size: 125m X 7.7m x 3m (hight)
- Requires two cabinets of sizw 4.3m X 3.0m X 3m (h) having 4.3mX 3m common partition (Total partitioning area: ~ 33sq.m)
- Five storage metallic campatments of total sizes (6.+7.7+2+4)m X1.1m x 0.5m)with grinite top = (~11 m<sup>3</sup>). **Maximum**
- Vertical Venetian blid window coverage :~ (3.m X 2.0 m) + ( 2m x 2.6m) = ~12sq.m
- Fire proof executive office table with Glass Top ~1665mm(W) x 300mm(D) x 725mm (H) with three drawer at each side: 2Nos.
- Fire proof computer tables ~1200m (w) x 450mm (W) x 750mm (h)
- High Back Chairs: 2Nos
- Guest low back chairs: 14Nos.
- 4ft x 3 ft white board with marker pens and dusturs: 2Nos.
- Fire proof “ L ” type compartment cum table with one set of drawer modules with provision for computer (~6’ X 5’) . 6Nos.
- Gas/water pipe line utility covering : ~2.7m x1m X2m = 5.4 sq.m

The details 3D layout is shown is shown in successive Page.

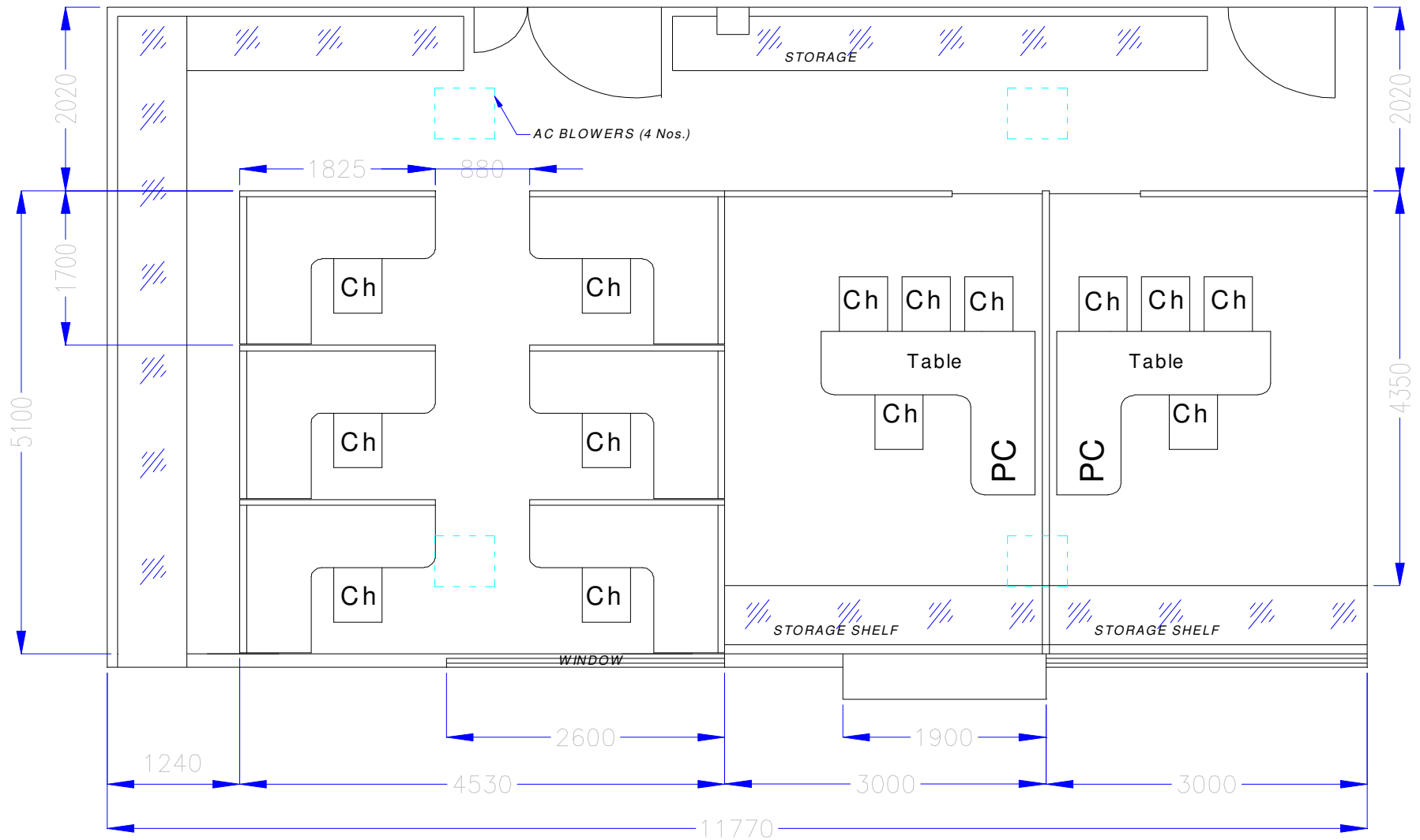

Room No.3 (L&PTD)

### Consolidate List of fabrication/Supply

Sr.No	Items	Qty
01	Aluminum partition using 14G Jindal make and 45 microns anodized aluminum sections, 5 mm clear Float Glass and 4 mm Aluminum composite panel with screws etc. With sliding doors on Godrej latch lock and handles on both sides.	~120
02	Area of Vertical vential blind curtain in sq.m	~48
03	Storage metallic compamtments in Cu.m ( having face area 28sq.m or 300sq.ft, made by 20Gauge MS sheet). <b>As specified by the user at site.</b>	~14
04	Fire proof executive office table with Glass top ~1165mm (W) x 300mm(D) x 725mm (H) with three drawer at each side and sleek drawer at mid	4Nos
05	Working “L” shaped table inclding provision for placir computers and printers, MASTREO Model, Godgej Make:	2No
06	High Back Chairs	06Nos
07	Low back chairs	32Nos.
08	Fire proof “ L ” type compartment cum table with one set of drawer modules with provision for computer (Two sets at R.No. & six sets at R.Nos.3) Size~6’ X 5’	8Nos.
09	Gas line/pieline/utility metallic coverage	8.5sq.m
10	Custom made “ [ ” table for student corner with provision for computer (~1200mm x 600mm X500mm depth)	



## Notes:

1. Supplier is requested to visit the site for getting clear idea about the quantum of work.
2. Wherever wood is used in furniture, fire retarded should be used.
3. Supplier should provide the brand name and attach the photo of the furniture to be supplied.
4. Both asthetic look and comfortable usage of furniture is preffered.
5. Photo attached are just indicative. Similar or better model have to be quoted.
6. The storage space as indicated in room's plan is indicate and maximum. But actual position of the storage space would be specified at site. This should be fire proof and having good astehetic look with grinite top.



## Executive Working Table

THRIVE+



## High Back Chairs



Low Back Chairs