



Government of India
BHABHA ATOMIC RESEARCH CENTRE
Accelerator and Pulse Power Division
Mumbai-400085- INDIA

Ref.: BARC/APPD/SGS/2018/ 67

Date:04/06/2018

Subject: Inviting quotations for minor fabrication of WR 112 straight waveguide made of ETP copper as per Annexure I.

You are requested to quote for Procurement of materials, fabrication and delivery at site as per annexure-I.

S. No.	Parts description	Quantity
1.	Procurement of materials, fabrication and delivery at site as per annexure-I.	8 Nos

- 1) For any clarifications the supplier can contact Shreya G Sarkar, SO/E, APPD on any working day (Monday to Friday) on telephone No. 25590167 or email: shreyag@barc.gov.in.
- 2) Payment for the above work will be made after satisfactory completion of job and on production of bill & advanced stamped receipt along with the copy of registration. No advance payment will be made for this work since ours is a Government organization. Only 5% GST (as applicable for R&D units) will be paid by BARC. Income-tax @ 2% & surcharge on Income-tax @15% will be deducted from the bill and a TDS (tax deducted at source) certificate will be issued as per Income-tax rules. Suppliers should submit their offers along with the following information:
 - (a) period of validity, terms & conditions of the offer.
 - (b) Approximate period of completion of the task and
 - (c) copy of the registration and income-tax clearance certificate and GSTIN.
- 3) The purchaser has the right to make the minor modifications in the design. Additional charges will not be admissible for such minor modifications, if any. The item should be delivered to us at **Engineering Hall4, APPD, BARC** after approval by our Scientists / Engineers. Please note that shorter delivery period will be preferred. Additional Information: Your sealed quotation (in your letter head) including all details, like taxes to be paid, transport charges etc., duly indicating our reference number mentioned above, due date & time of opening of quotations on the envelop, may be sent to “**Head, APPD, Engg. Hall No.4, Trombay, MUMBAI-400085**”, by **21st June 2018**. It is requested that the tender may be sent by Speed-post, so that it can reach us in time. The quotations will be opened on the next day. The quotations received after the due date & by FAX/email will not be considered.

(S. G. Sarkar)
(SO/E APPD, BARC)

ANNEXURE 1

1. WR 112 waveguide to n type coaxial right angle adaptor with CPR112F Flange

Electrical/Mechanical Specifications:

- 1 Waveguide size: WR112
2. Frequency range: 7.05-10 GHz
3. VSWR (Max): 1.25
4. Insertion loss: 0.15
5. Material: Brass
6. CW Power 200W
7. Peak Power: 3 kW
8. Cover flange: CPR112F
9. Connector type: N type (female)
10. Quantity Required: 4 Nos

2. WR 112 waveguide to n type coaxial right angle adaptor with UG138/U Flange

Electrical/Mechanical Specifications:

- 1 Waveguide size: WR112
2. Frequency range: 7.05-10 GHz
3. VSWR (Max): 1.25
4. Insertion loss: 0.15
5. Material: Brass
6. CW Power 200W
7. Peak Power: 3 kW
8. Cover flange: UG 138/U
9. Connector type: N type (female)
10. Quantity Required: 4 Nos



Drawing Outline

All the dimensions are in mm

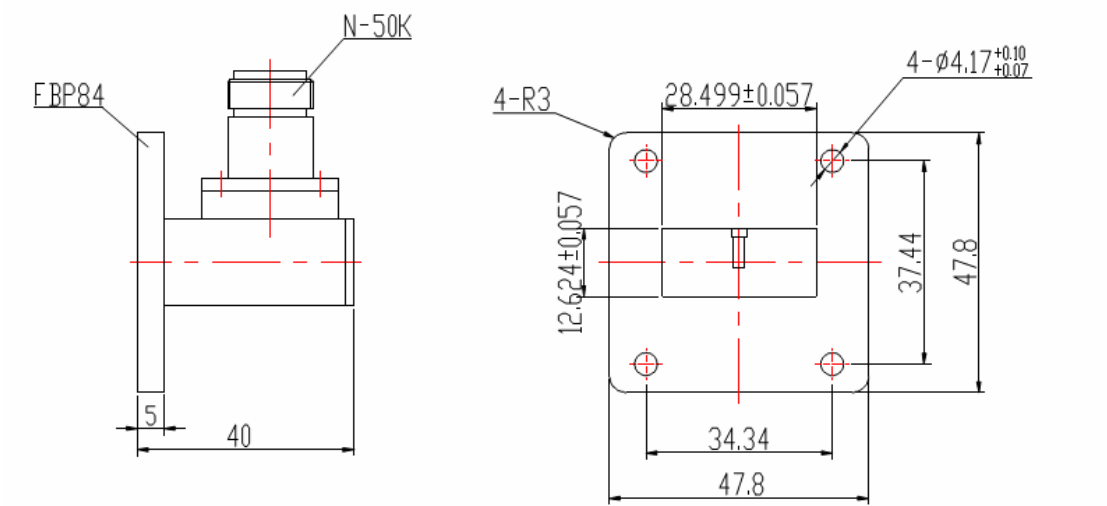

THIS DESIGN AND DRAWING IS THE PROPERTY OF BHABHA ATOMIC RESEARCH CENTRE. IT MUST BE RETURNED WITH QUOTATION OR UPON DELIVERY OF MATERIAL AND EQUIPMENT MUST NOT BE USED EXCEPT BY PERMISSION OF THE OWNER.

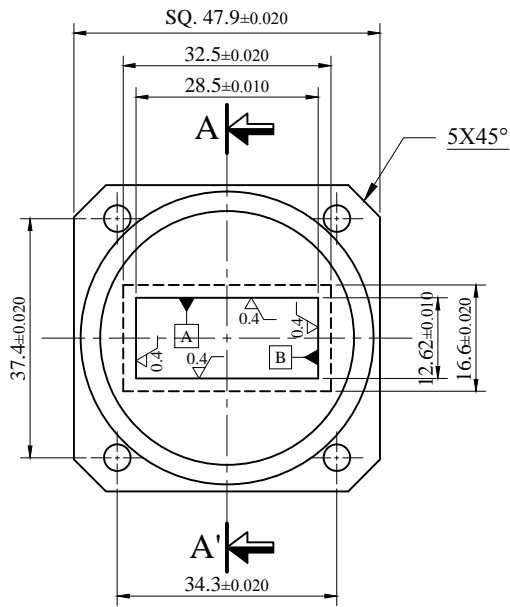

SIDE VIEW

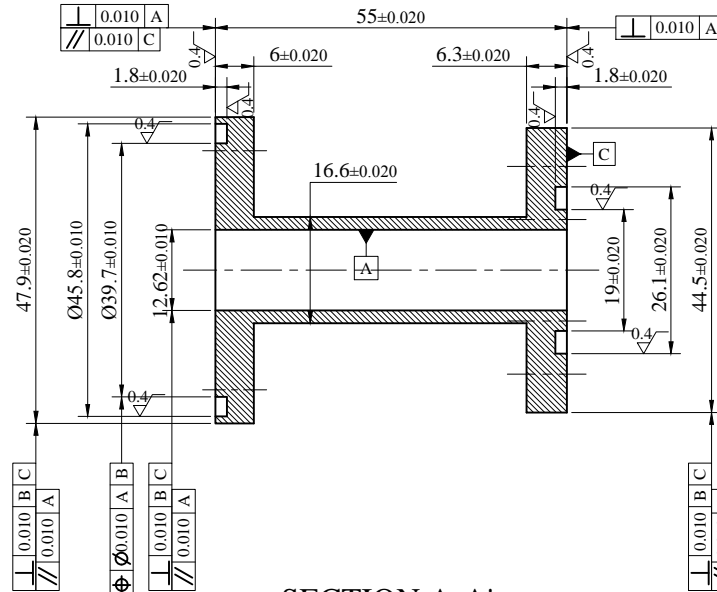

SECTION A-A'

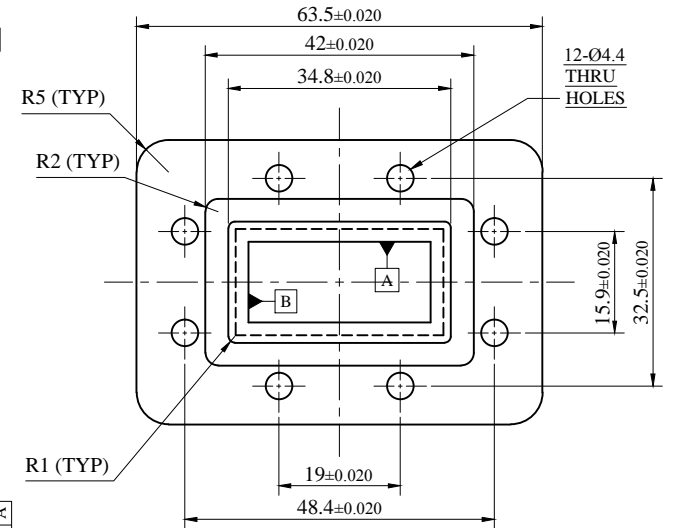

SIDE VIEW

MATERIAL - BRASS
QUANTITY - 01 No.

NOTE:

1. ALL OVER SURFACE FINISH 0.8 MICRONS OR BETTER IF NOT SPECIFIED.
2. REMOVE ALL BURRS AND SHARP CORNERS. EDGES TO R=0.1 MAX.

PART NO.: 01

FILE No.:		W.O. NO.:		CODE NO.:	
PROJECT OR SECTION		TITLE :		APP'D:	
		DETAIL OF		SHEET NO. OF SHTS.	
		WAVEGUIDE ADAPTOR		SCALE: N.T.S.	
DR N/DATE: MANJUNATHA/25.05.18		UG51/U WITH GROOVE - CPR112G		PROJN.	
DRG. CHKD.:				DRG NO.	
DES'D.:				REFLX/WG/1	
				REV. 0	

NO.	LOC.	DESCRIPTION	DRN DATE	APP'D. DATE
REVISIONS				

GENERAL TOLERANCE UNLESS OTHERWISE SPECIFIED		
LINEAR DIMENSIONS	LENGTH OF SHORTER SIDE OF ANGLE	SURFACE FINISH IN MICRONS
UPTO 6 ± 0.1	1- 6 ± 1°	3.15√CLA
6 - 30 ± 0.2	6 - 30 ± 0° 30'	CHAMFER 1 x 45°
30 - 120 ± 0.3	30 - 120 ± 0° 20'	
120 - 315 ± 0.5	120 - 400 ± 0° 10'	
315 - 1000 ± 0.8		
1000 - 2000 ± 1.2	1. ALL DIMENSIONS ARE IN MILLIMETERS.	
2000 - 4000 ± 2.0	2. REMOVE SHARP CORNERS AND BURRS.	

THIS DESIGN AND DRAWING IS THE PROPERTY OF BHABHA ATOMIC RESEARCH CENTRE
IT MUST BE RETURNED WITH QUOTATION OR UPON DELIVERY OF MATERIAL AND
EQUIPMENT MUST NOT BE USED EXCEPT BY PERMISSION OF THE OWNER.

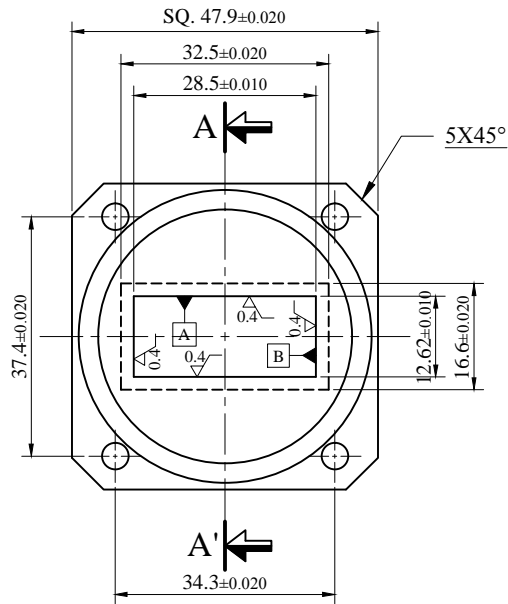

SIDE VIEW

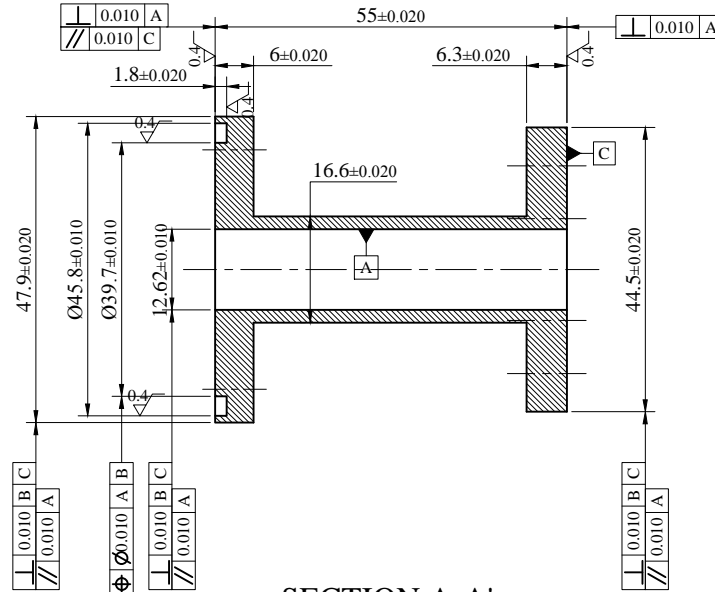

SECTION A-A'

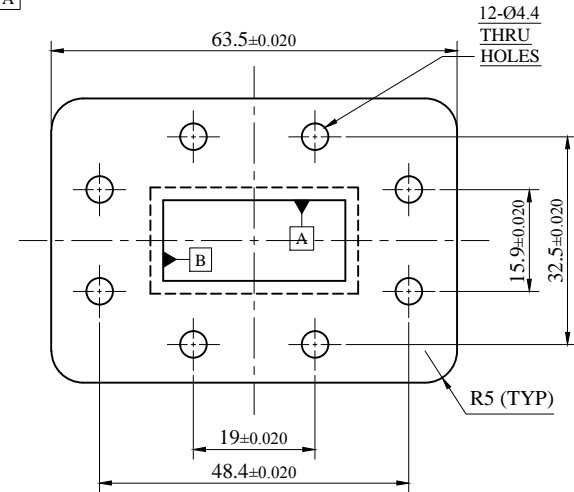

SIDE VIEW

MATERIAL - BRASS
QUANTITY - 02 No.

NOTE:

- ALL OVER SURFACE FINISH 0.8 MICRONS OR BETTER IF NOT SPECIFIED.
- REMOVE ALL BURRS AND SHARP CORNERS. EDGES TO R=0.1 MAX.

PART NO.: 02

				FILE No.:	W.O. NO.:	CODE NO.:																																																					
				PROJECT OR SECTION	TITLE : DETAIL OF WAVEGUIDE ADAPTOR UG51/U WITH GROOVE - CPR112F																																																						
				DR'N/DATE: MANJUNATHA/25.05.18	APP'D: SHEET NO. OF SHTS.																																																						
				DRG. CHKD.:	SCALE: N.T.S.																																																						
				DES'D.:	PROJN.	REV.																																																					
				DRG NO. RFLX/WG/2		REV. 0																																																					
<table border="1"> <thead> <tr> <th colspan="6">GENERAL TOLERANCE UNLESS OTHERWISE SPECIFIED</th> </tr> <tr> <th colspan="2">LINEAR DIMENSIONS</th> <th>LENGTH OF SHORTER SIDE OF ANGLE</th> <th colspan="3">SURFACE FINISH IN MICRONS</th> </tr> </thead> <tbody> <tr> <td>UPTO 6</td> <td>± 0.1</td> <td>1 - 6</td> <td colspan="3">3.15√CLA</td> </tr> <tr> <td>6 - 30</td> <td>± 0.2</td> <td>1 - 6</td> <td colspan="3">CHAMFER 1 x 45°</td> </tr> <tr> <td>30 - 120</td> <td>± 0.3</td> <td>6 - 30</td> <td colspan="3">± 0° 30'</td> </tr> <tr> <td>120 - 315</td> <td>± 0.5</td> <td>30 - 120</td> <td colspan="3">± 0° 20'</td> </tr> <tr> <td>315 - 1000</td> <td>± 0.8</td> <td>120 - 400</td> <td colspan="3">± 0° 10'</td> </tr> <tr> <td>1000 - 2000</td> <td>± 1.2</td> <td colspan="4">1. ALL DIMENSIONS ARE IN MILLIMETERS.</td> </tr> <tr> <td>2000 - 4000</td> <td>± 2.0</td> <td colspan="4">2. REMOVE SHARP CORNERS AND BURRS.</td> </tr> </tbody> </table>				GENERAL TOLERANCE UNLESS OTHERWISE SPECIFIED						LINEAR DIMENSIONS		LENGTH OF SHORTER SIDE OF ANGLE	SURFACE FINISH IN MICRONS			UPTO 6	± 0.1	1 - 6	3.15√CLA			6 - 30	± 0.2	1 - 6	CHAMFER 1 x 45°			30 - 120	± 0.3	6 - 30	± 0° 30'			120 - 315	± 0.5	30 - 120	± 0° 20'			315 - 1000	± 0.8	120 - 400	± 0° 10'			1000 - 2000	± 1.2	1. ALL DIMENSIONS ARE IN MILLIMETERS.				2000 - 4000	± 2.0	2. REMOVE SHARP CORNERS AND BURRS.					
GENERAL TOLERANCE UNLESS OTHERWISE SPECIFIED																																																											
LINEAR DIMENSIONS		LENGTH OF SHORTER SIDE OF ANGLE	SURFACE FINISH IN MICRONS																																																								
UPTO 6	± 0.1	1 - 6	3.15√CLA																																																								
6 - 30	± 0.2	1 - 6	CHAMFER 1 x 45°																																																								
30 - 120	± 0.3	6 - 30	± 0° 30'																																																								
120 - 315	± 0.5	30 - 120	± 0° 20'																																																								
315 - 1000	± 0.8	120 - 400	± 0° 10'																																																								
1000 - 2000	± 1.2	1. ALL DIMENSIONS ARE IN MILLIMETERS.																																																									
2000 - 4000	± 2.0	2. REMOVE SHARP CORNERS AND BURRS.																																																									
NO.	LOC.	DESCRIPTION	DR'N DATE	APP'D. DATE																																																							
REVISIONS																																																											

A B C D E F G H

THIS DESIGN AND DRAWING IS THE PROPERTY OF BHABHA ATOMIC RESEARCH CENTRE
IT MUST BE RETURNED WITH QUOTATION OR UPON DELIVERY OF MATERIAL AND
EQUIPMENT MUST NOT BE USED EXCEPT BY PERMISSION OF THE OWNER.

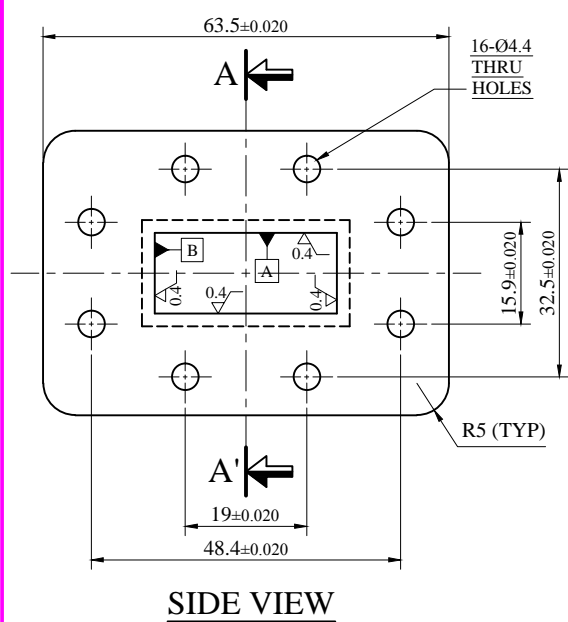

SIDE VIEW

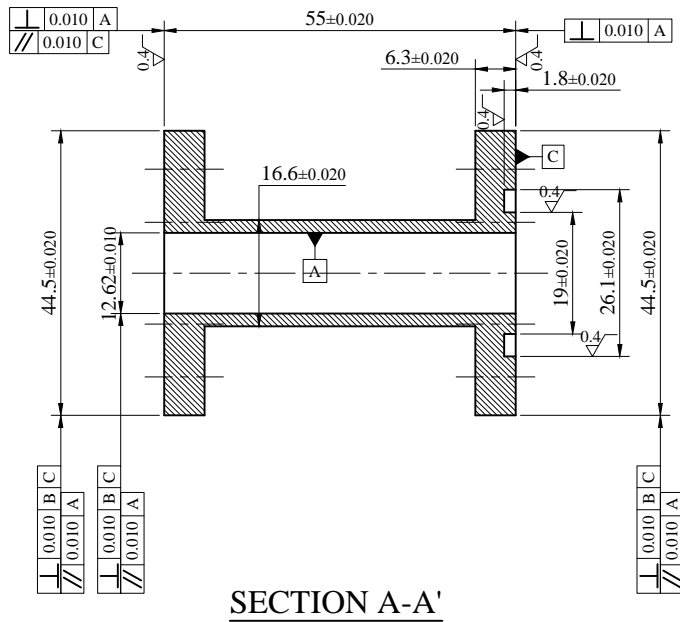

SECTION A-A'

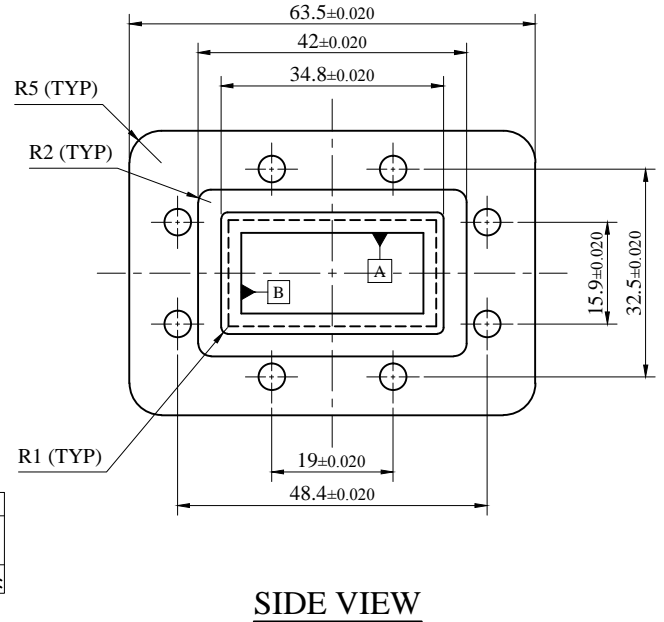

SIDE VIEW

MATERIAL - BRASS
QUANTITY - 01 No.

NOTE:

1. ALL OVER SURFACE FINISH 0.8 MICRONS OR BETTER IF NOT SPECIFIED.
2. REMOVE ALL BURRS AND SHARP CORNERS. EDGES TO R=0.1 MAX.

PART NO.: 03

				FILE No.:	W.O. NO.:	CODE NO.:																																					
				PROJECT OR SECTION	TITLE: DETAIL OF WAVEGUIDE ADAPTOR CPR112F - CPR112G																																						
				DR'N/DATE: MANJUNATHA/25.05.18	APP'D: SHEET NO. OF SHTS.																																						
				DRG. CHKD.:	SCALE: N.T.S.																																						
				DES'D.:	PROJN.																																						
				DRG NO. REFLX/WG/3		REV. 0																																					
<table border="1"> <thead> <tr> <th>NO.</th> <th>LOC.</th> <th>DESCRIPTION</th> <th>DR'N DATE</th> <th>APP'D. DATE</th> </tr> </thead> <tbody> <tr> <td colspan="5">REVISIONS</td> </tr> </tbody> </table>				NO.	LOC.	DESCRIPTION	DR'N DATE	APP'D. DATE	REVISIONS					<table border="1"> <thead> <tr> <th colspan="3">GENERAL TOLERANCE UNLESS OTHERWISE SPECIFIED</th> </tr> </thead> <tbody> <tr> <td>LINEAR DIMENSIONS</td> <td>LENGTH OF SHORTER SIDE OF ANGLE</td> <td>SURFACE FINISH IN MICRONS</td> </tr> <tr> <td>UPTO 6 ± 0.1</td> <td>1- 6 ± 1°</td> <td>3.15√CLA</td> </tr> <tr> <td>6 - 30 ± 0.2</td> <td>6 - 30 ± 0° 30'</td> <td>CHAMFER 1 x 45°</td> </tr> <tr> <td>30 - 120 ± 0.3</td> <td>30 - 120 ± 0° 20'</td> <td></td> </tr> <tr> <td>120 - 315 ± 0.5</td> <td>120 - 400 ± 0° 10'</td> <td></td> </tr> <tr> <td>315 - 1000 ± 0.8</td> <td></td> <td></td> </tr> <tr> <td>1000 - 2000 ± 1.2</td> <td colspan="2">1. ALL DIMENSIONS ARE IN MILLIMETERS.</td> </tr> <tr> <td>2000 - 4000 ± 2.0</td> <td colspan="2">2. REMOVE SHARP CORNERS AND BURRS.</td> </tr> </tbody> </table>			GENERAL TOLERANCE UNLESS OTHERWISE SPECIFIED			LINEAR DIMENSIONS	LENGTH OF SHORTER SIDE OF ANGLE	SURFACE FINISH IN MICRONS	UPTO 6 ± 0.1	1- 6 ± 1°	3.15√CLA	6 - 30 ± 0.2	6 - 30 ± 0° 30'	CHAMFER 1 x 45°	30 - 120 ± 0.3	30 - 120 ± 0° 20'		120 - 315 ± 0.5	120 - 400 ± 0° 10'		315 - 1000 ± 0.8			1000 - 2000 ± 1.2	1. ALL DIMENSIONS ARE IN MILLIMETERS.		2000 - 4000 ± 2.0	2. REMOVE SHARP CORNERS AND BURRS.	
NO.	LOC.	DESCRIPTION	DR'N DATE	APP'D. DATE																																							
REVISIONS																																											
GENERAL TOLERANCE UNLESS OTHERWISE SPECIFIED																																											
LINEAR DIMENSIONS	LENGTH OF SHORTER SIDE OF ANGLE	SURFACE FINISH IN MICRONS																																									
UPTO 6 ± 0.1	1- 6 ± 1°	3.15√CLA																																									
6 - 30 ± 0.2	6 - 30 ± 0° 30'	CHAMFER 1 x 45°																																									
30 - 120 ± 0.3	30 - 120 ± 0° 20'																																										
120 - 315 ± 0.5	120 - 400 ± 0° 10'																																										
315 - 1000 ± 0.8																																											
1000 - 2000 ± 1.2	1. ALL DIMENSIONS ARE IN MILLIMETERS.																																										
2000 - 4000 ± 2.0	2. REMOVE SHARP CORNERS AND BURRS.																																										

THIS DESIGN AND DRAWING IS THE PROPERTY OF BHABHA ATOMIC RESEARCH CENTRE
IT MUST BE RETURNED WITH QUOTATION OR UPON DELIVERY OF MATERIAL AND
EQUIPMENT MUST NOT BE USED EXCEPT BY PERMISSION OF THE OWNER.

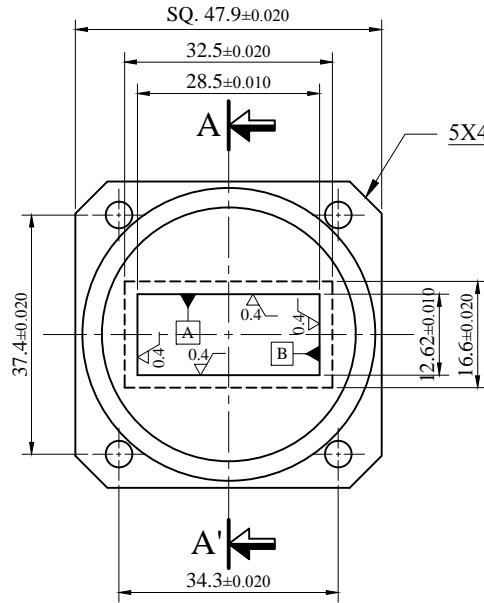

SIDE VIEW

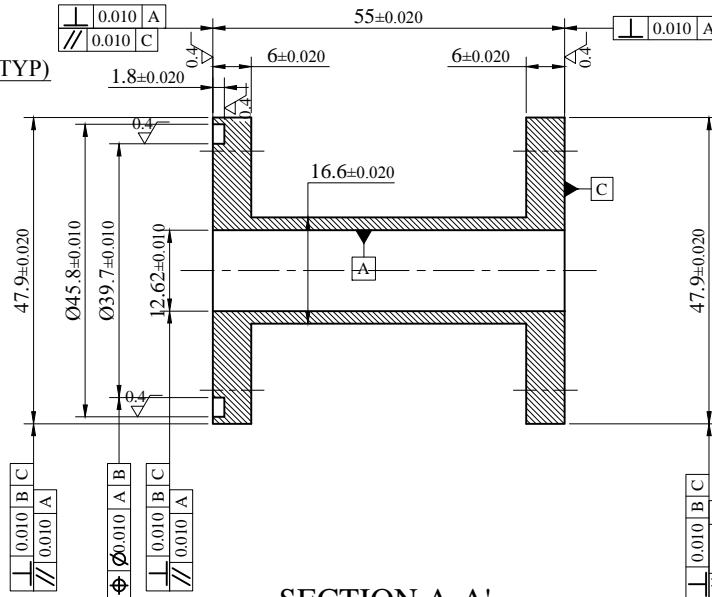

SECTION A-A'

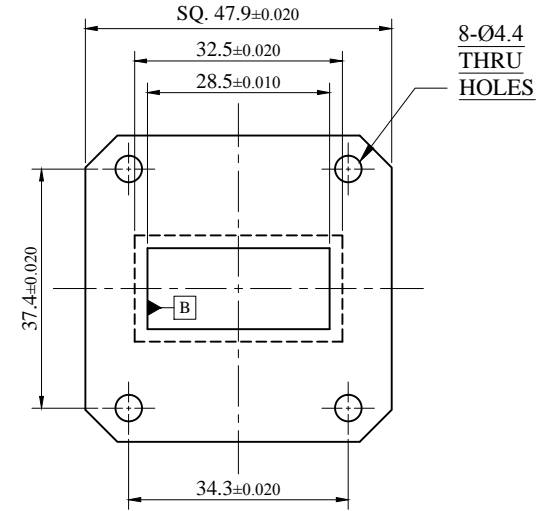

SIDE VIEW

**MATERIAL - BRASS
QUANTITY - 01 No.**

NOTE:

1. ALL OVER SURFACE FINISH 0.8 MICRONS OR BETTER IF NOT SPECIFIED.
2. REMOVE ALL BURRS AND SHARP CORNERS. EDGES TO R=0.1 MAX.

PART NO.: 04

FILE No.:	W.O. NO.:	CODE NO.:
PROJECT OR SECTION	TITLE : DETAIL OF WAVEGUIDE ADAPTOR UG51/U WITH GROOVE - W/O GROOVE	
DR N/DATE: MANJUNATHA/25.05.18	APP'D:	SHEET NO. OF SHTS.
DRG. CHKD.:	SCALE: N.T.S.	PROJN.
DES'D.:	DRG NO. RFLX/WG/4	REV. 0

NO.	LOC.	DESCRIPTION	DRN DATE	APP'D. DATE
REVISIONS				

GENERAL TOLERANCE UNLESS OTHERWISE SPECIFIED		
LINEAR DIMENSIONS	LENGTH OF SHORTER SIDE OF ANGLE	SURFACE FINISH IN MICRONS
UPTO 6 ± 0.1	1- 6 ± 1°	3.15√CLA
6 - 30 ± 0.2	6 - 30 ± 0° 30'	CHAMFER 1 x 45°
30 - 120 ± 0.3	30 - 120 ± 0° 20'	
120 - 315 ± 0.5	120 - 400 ± 0° 10'	
315 - 1000 ± 0.8		
1000 - 2000 ± 1.2	1. ALL DIMENSIONS ARE IN MILLIMETERS.	
2000 - 4000 ± 2.0	2. REMOVE SHARP CORNERS AND BURRS.	

A B C D E F G H